

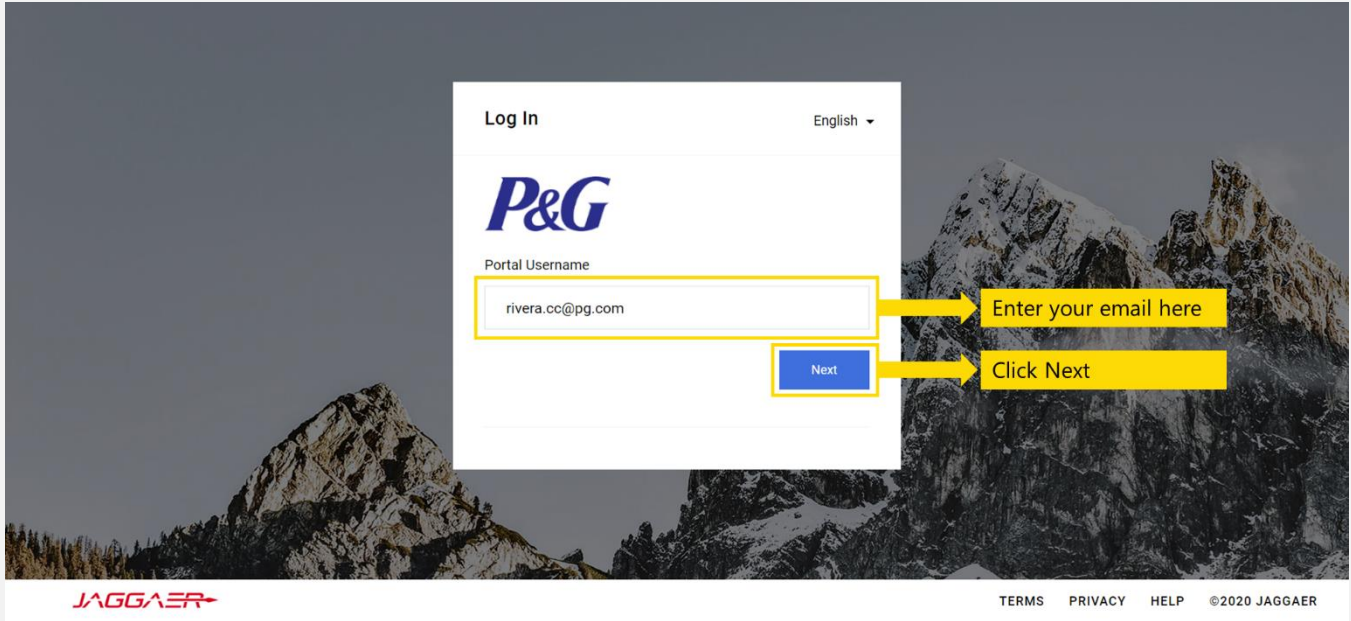

Step 1: Go to <https://app12.jaggaer.com/portals/pg2>.

Step 2: Enter your **email** then click **Next**.



Step 2: Enter your **password** then click **Login**.

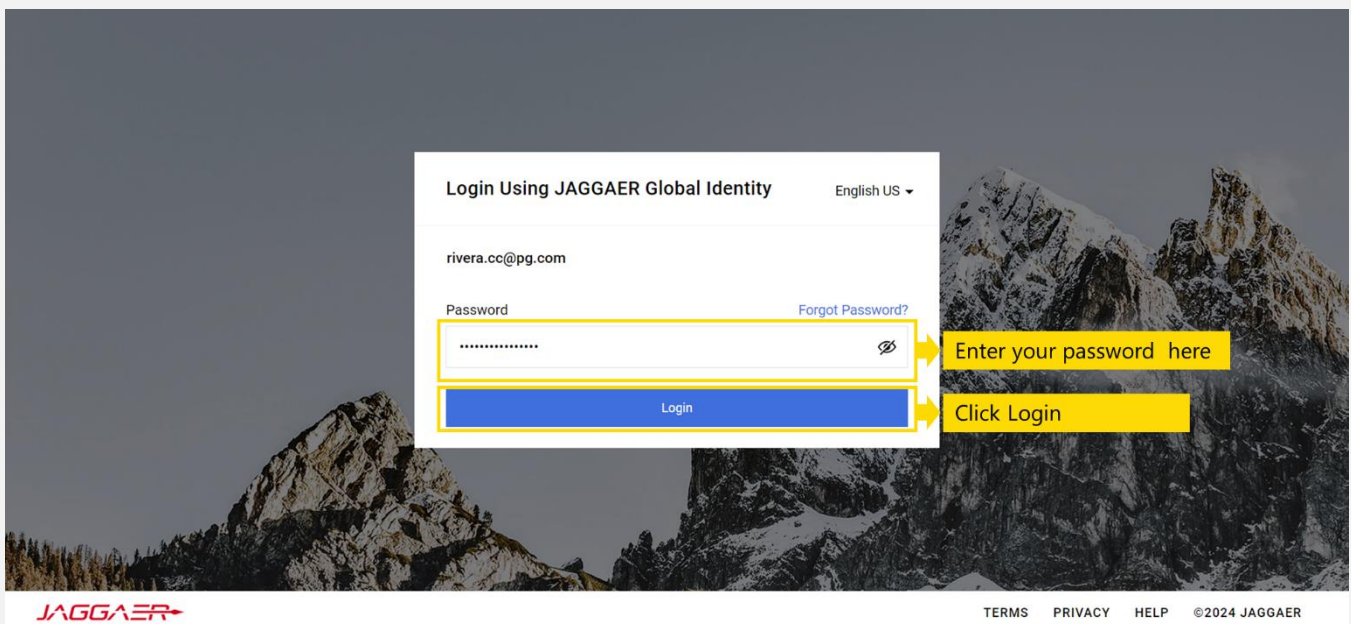

Step 3: A one time code will be sent to your chosen channel. In the sample below, the chosen channel is email. Enter the one time-code received then click Submit.

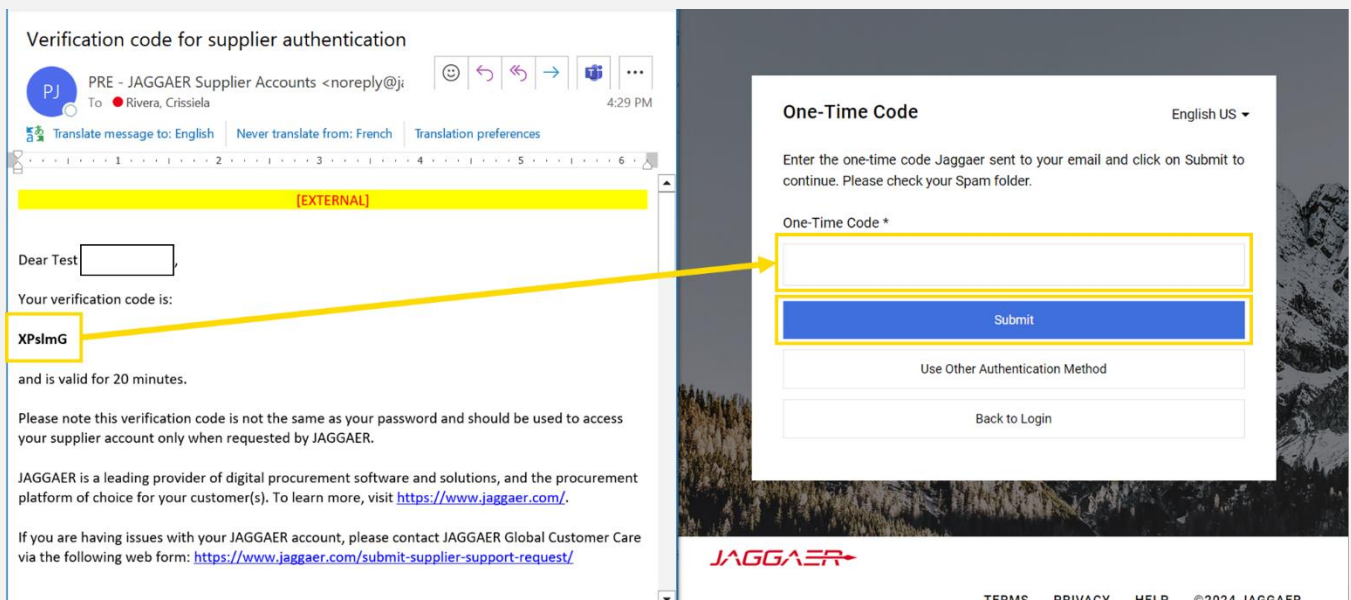

Extra step for those with multiple accounts: For those with Jaggaer multiple accounts, you will be asked which account you want to login. Click the account you want to log-in to.

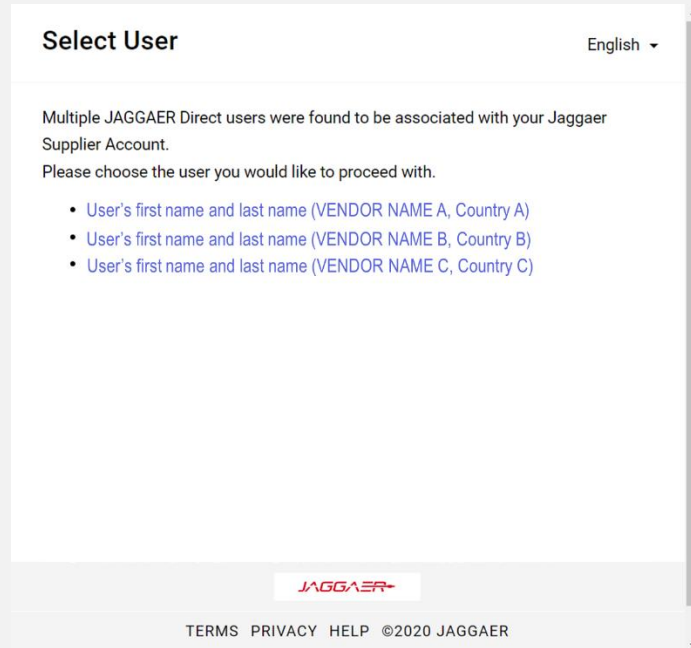

After clicking your preferred account, enter your email and password again then click Login.

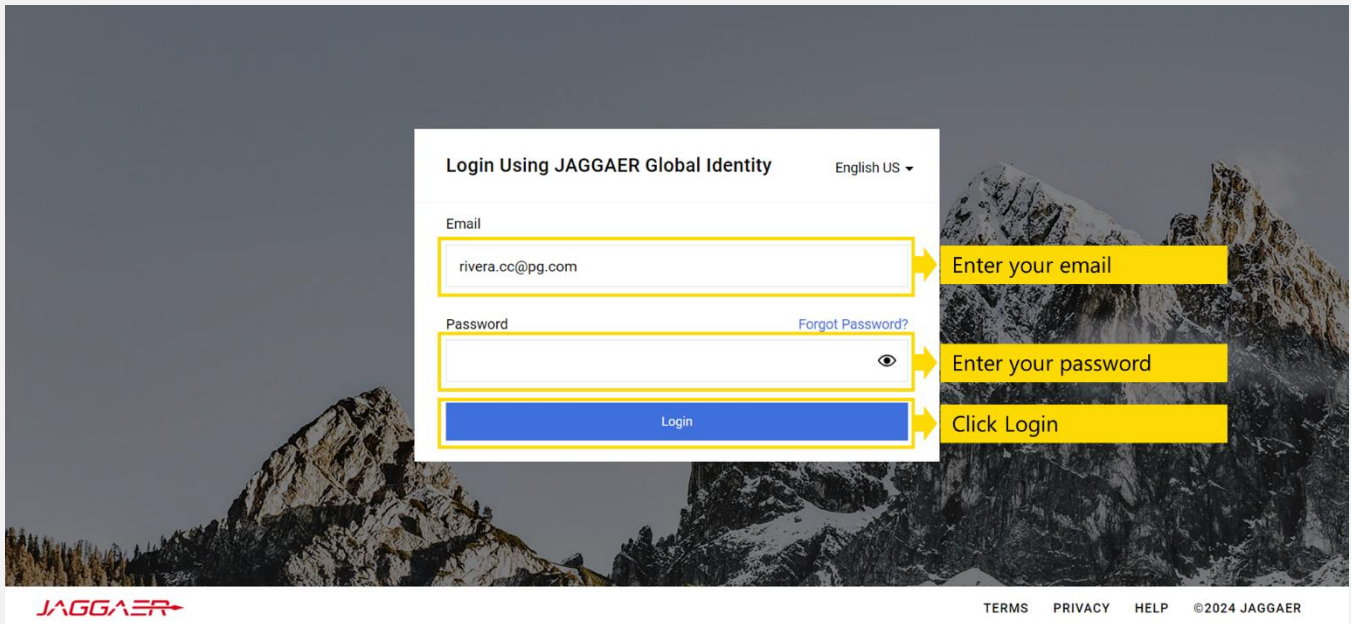

Done:

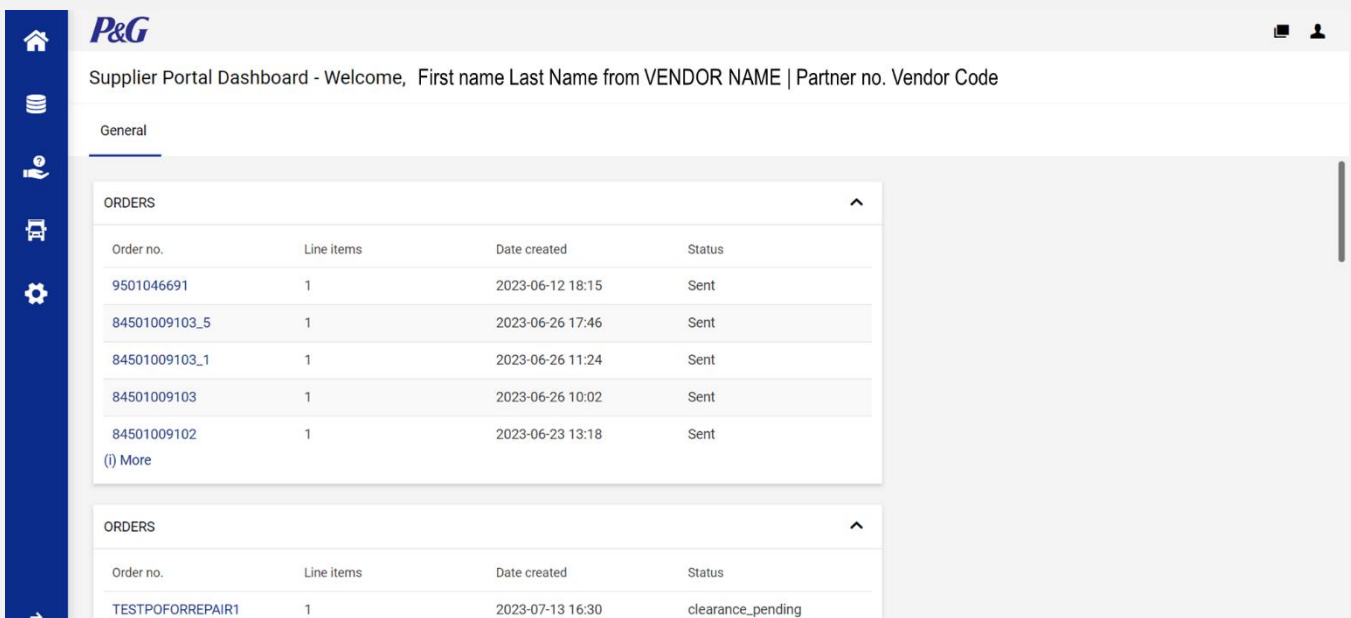

For any technical issues encountered, follow the links below:

Jaggaer support for suppliers - webform	https://jaggaer.my.site.com/SupplierSupportRequest/s/
Jaggaer supplier support portal	https://www.jaggaer.com/supplier-support
Jaggaer Support Global Phone numbers	https://www.jaggaer.com/support/support-phone-numbers
Any issues or questions on PO	P&G contact on purchase order